

Project Name:	Location:	MFG: Hanover Lantern
Fixture Type:	Catalog No.:	Qty:

**Ordering Guide**

Example: FLA121BLK

<b>Product Code</b>	FLA121	Floodlight
<b>Finish</b>	BLK	Black
	VGN	Verde
	BRZ	Bronze

**Measurements**

<b>Height</b>	4 7/8" (123mm)
<b>Width</b>	6 7/8" (175mm)
<b>Depth</b>	5" (127mm)
<b>Max. Weight</b>	1.8 lb.

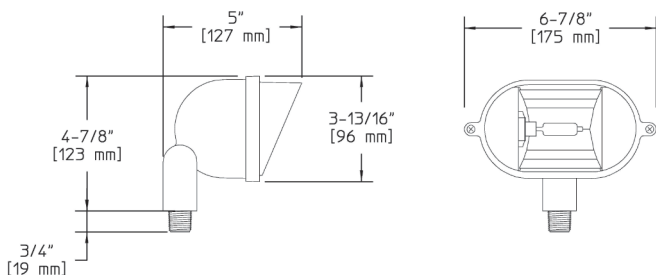

**Specifications**

**Housing:**

Double gasketed shroud, die-cast aluminum. Die-cast aluminum. Fully-adjustable swivel arm with vibration-proof locking teeth. Fasteners are 300 series stainless steel. 1/2" NPS male threads to screw on to accessory mounting stake or junction box, sold separately.

**Finish:**

Thermoset polyester powdercoat is electrostatically applied after a five-stage conversion cleaning process and bonded by heat fusion thermosetting.

**Optical Assembly:**

Clear tempered glass, fully gasketed.

**Lamping:**

50W maximum T4 halogen is included. Lower wattage lamps are acceptable.

**Electrical Assembly:**

Bi-pin socket type (GY6.35) with 250° C high temperature teflon coated wire leads. 12 volt fixture is pre-wired with 3-ft pigtail of 18-2 AWG, 105° C, SPT-1 wire. Low voltage quick connector (catalog #GLVC3) included for easy hook-up to the low voltage supply cable, not included. 12 volt system requires remote transformer, not included.

**Warranty:**

Three-year limited warranty.

**Certification:**

UL listed to U.S. safety standards for wet locations. cUL listed to Canadian safety standards for wet locations. Manufactured to ISO 9001:2000 Standards.

**Accessories:**

- GS1 Mounting Stake.
- GS7 Mounting Stake.
- GS8 Mounting Stake.
- FLA14 Louver.